

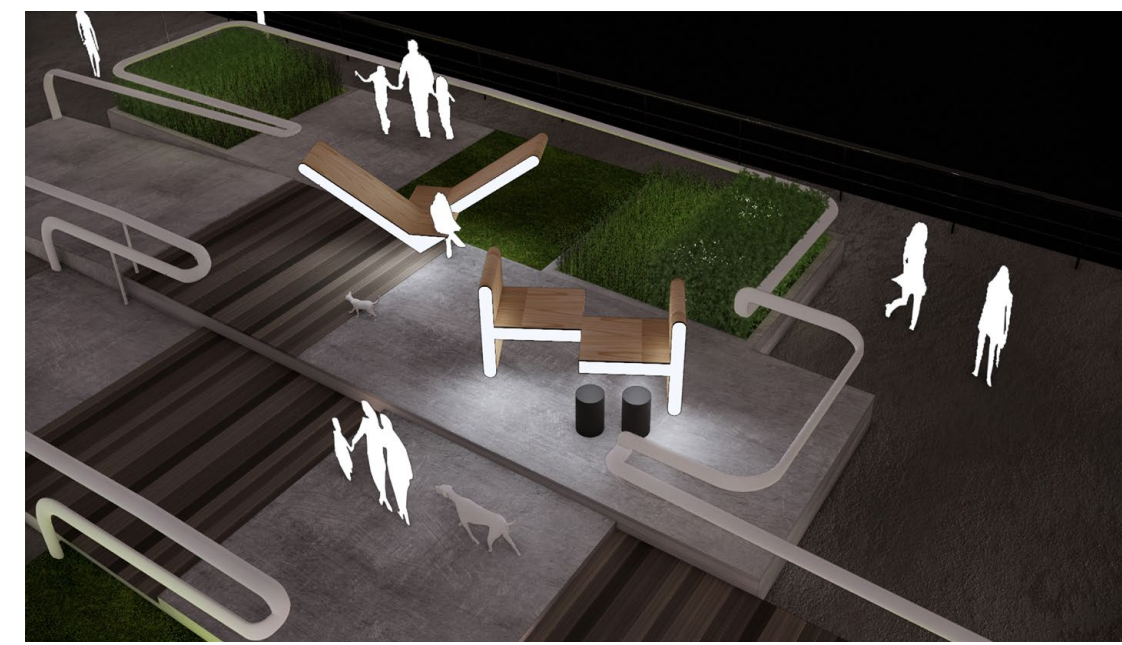

PLAY RING!  
(designed by Mak Chihong)



The 60s view  
(designed by Lee Loksun and his team)



Anamorphosis  
(designed by Wai Tang and his team)



WAVE  
(designed by Rachel Lee)



Dynamic and Colorful Waves  
(designed by Bill Mo)

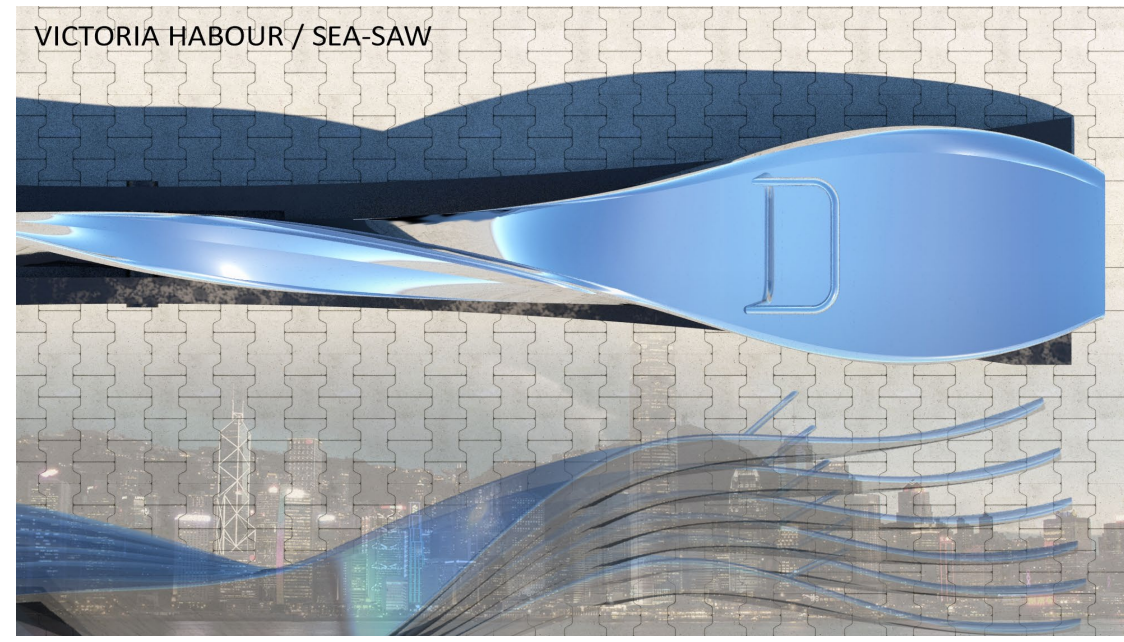

SEA-SAW  
(designed by Ho Tsunming)



Social Ring  
(designed by Arnold Wong)

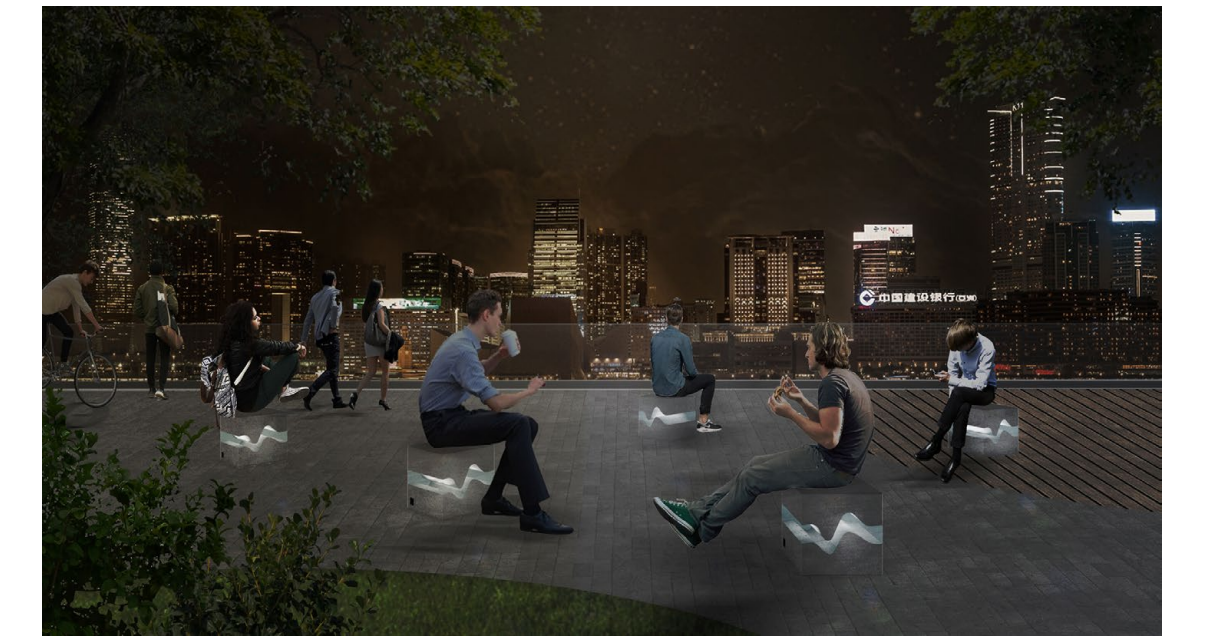

Aqua Cube  
(designed by Kenneth Wong)



Wanchai Coastline Bench  
(designed by Kevin Yim and his team)

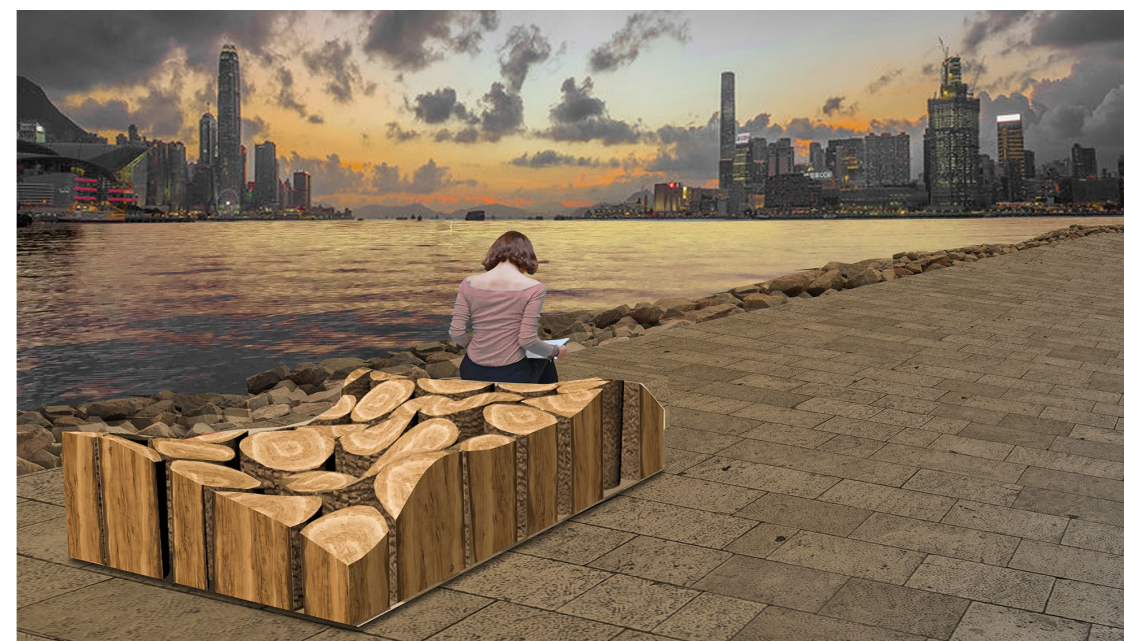

Endurance of Stricken Woods  
(designed by Charles Lai and his team)

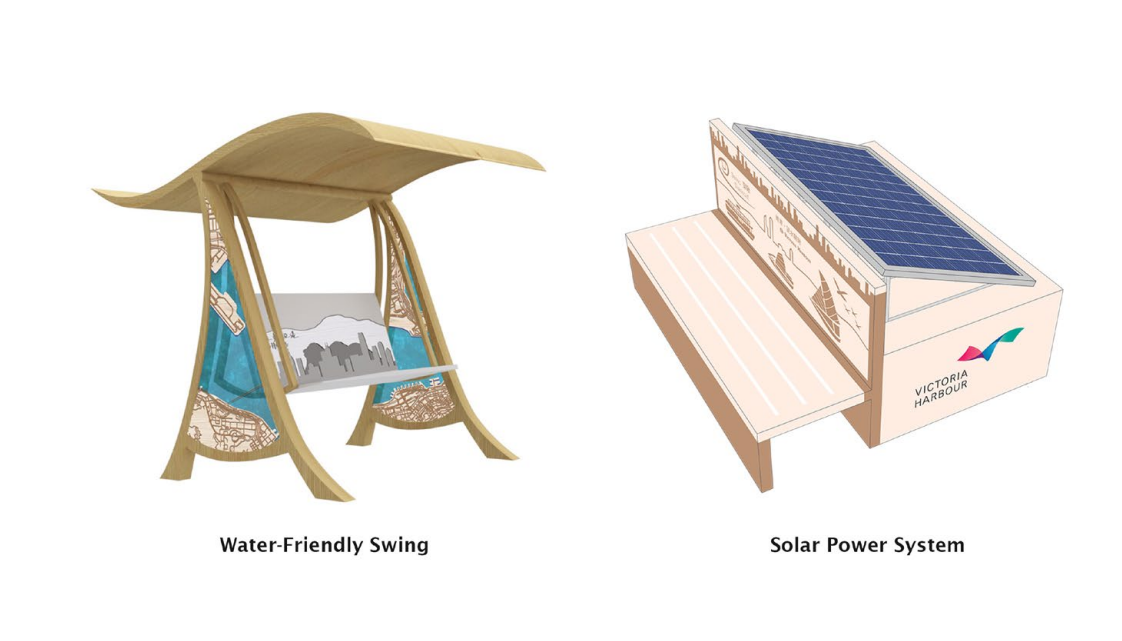

Swing Through  
(designed by Gordon Foo and his team)



Dialogue at Distance  
(designed by Weldon Lee)



Urban Pebbles  
(designed by Jason Hilgert and his team)

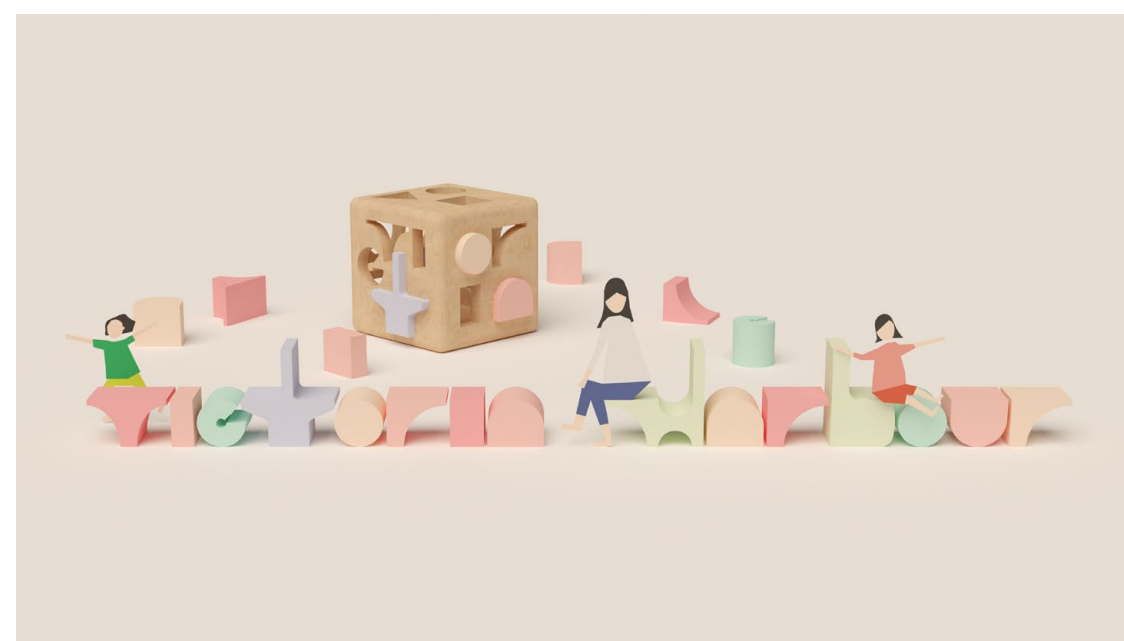

VH Puzzled  
(designed by Samuel Wong and his team)

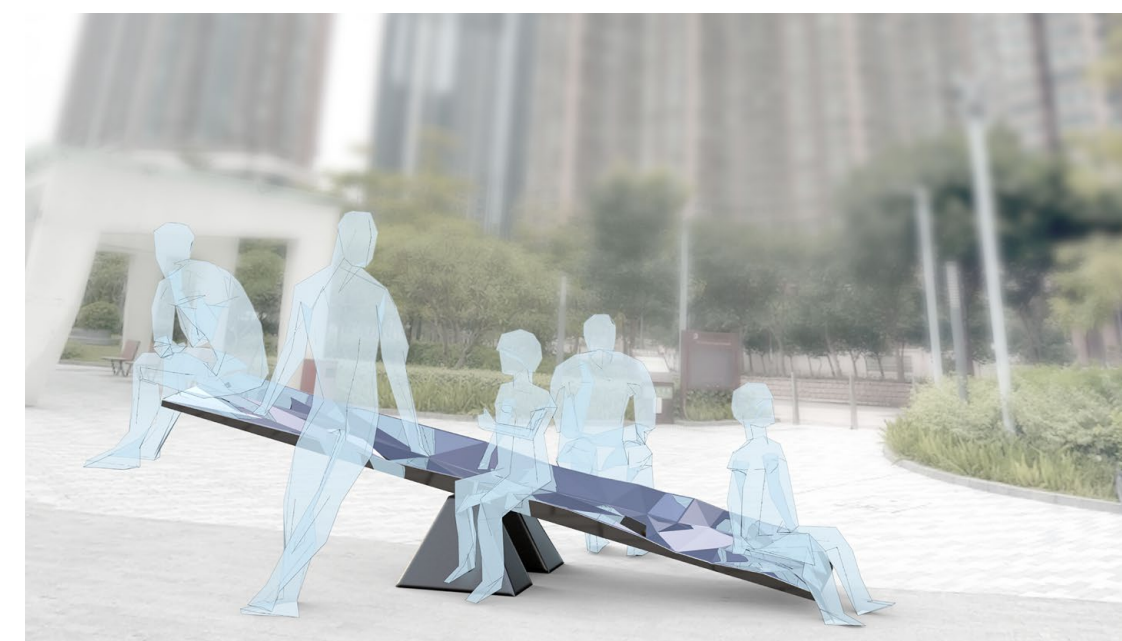

Sit-easy  
(designed by Yeung Lishung and his team)

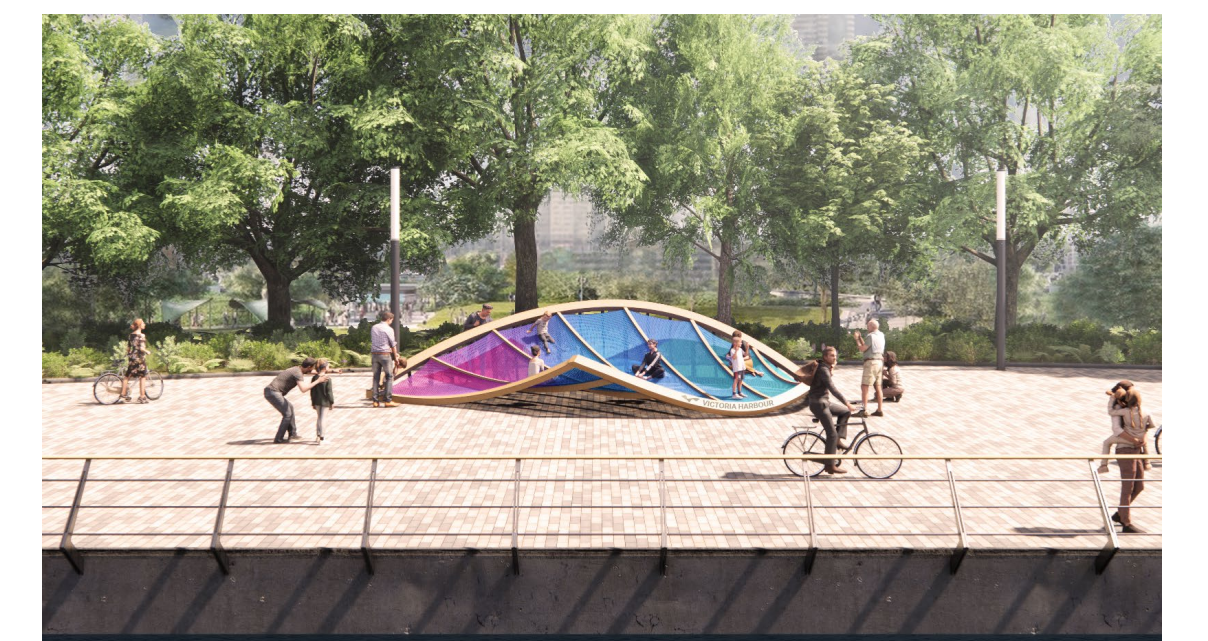

Victoria Vessel  
(designed by Wong Longhin and his team)

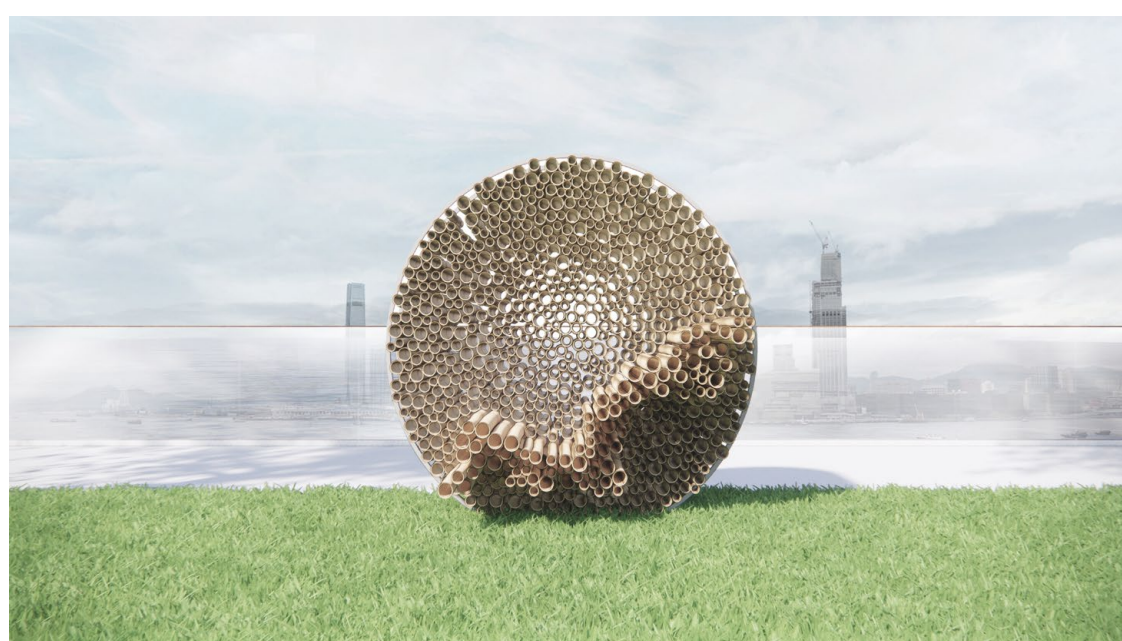

Insignificance  
(designed by Ng Loksum and her team)

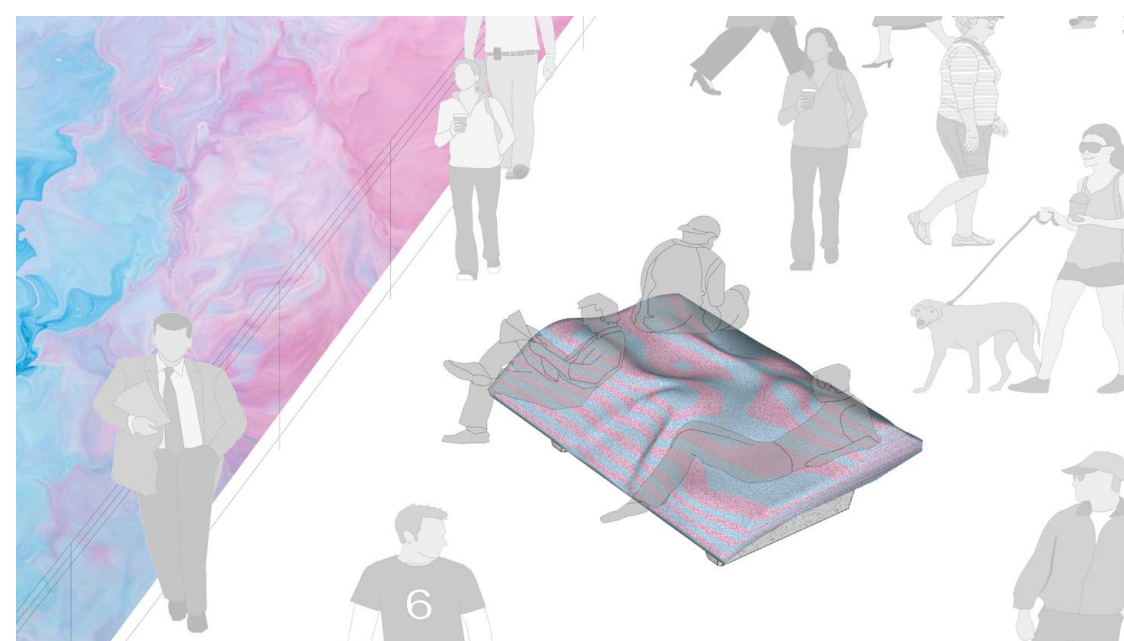

By the Harbour  
(designed by Chui Kaihin and his team)

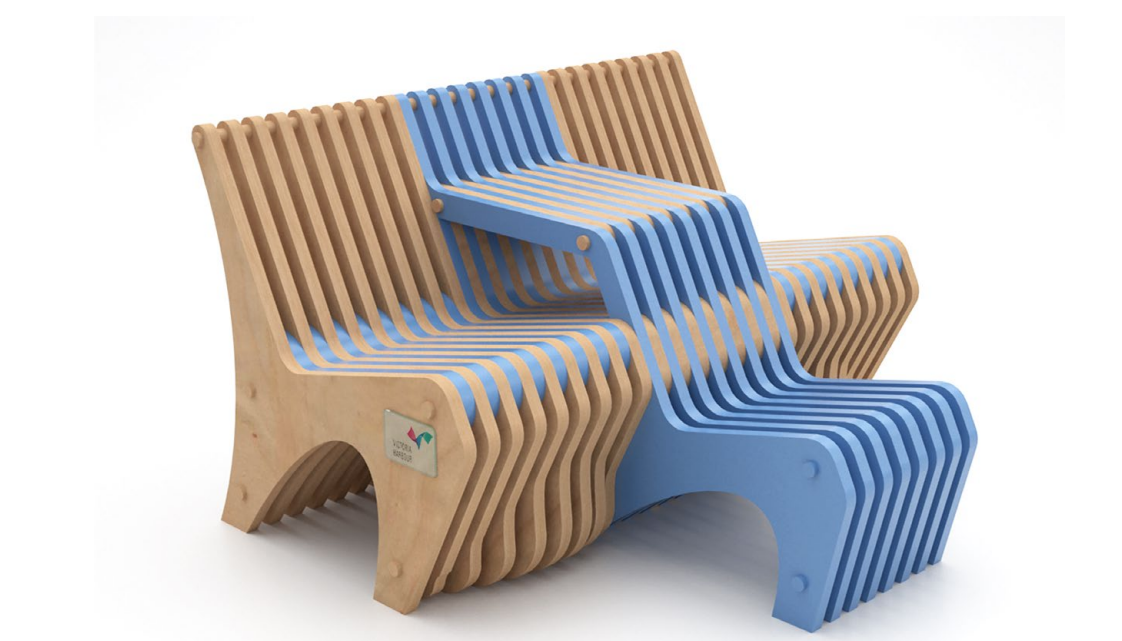

The Weave Chair  
(designed by Cho Lokman)



Sin Siesta  
(designed by Wilson Sin)